

# MGR-H12400Z

INDUSTRIAL AC SOLID STATE RELAYS (HIGH VOLTAGE TYPE)



## Type meaning

**MGR** - **H**: [Elongated] - **12**: [Load voltage 30-1200VAC] - **400** :[400A] -**Z**: [Zero-crossing type]

## Features

- Rated current: 400Amps
- Rated voltage: 30-1200VAC
- Control voltage: 3-32VDC
- Control current:  $\leq 10\text{mA}$
- Reverse-parallel SCR as the output component can be used in commercial or heavy industrial applications with reliable performance
- "Ultra low" input current
- Low output off-state leakage current
- Low output on-state voltage drop
- Display output status via LED
- Standard output RC snubber circuit

## Notice

- If the load current is 10A, a heat sink must be equipped; if the load current is 40A or more, an air-cooled radiator or a water-cooled radiator must be installed.
- When the load is an inductive load, be sure to connect a varistor in parallel with the output terminal, whose voltage value is 1.6-1.9 times the load voltage.

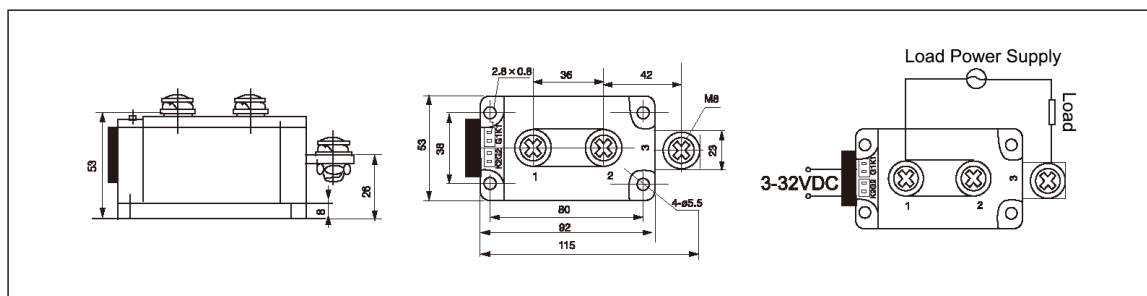

Note: Specific voltage can be customized.